

Jordan+Bateman Architects

ARCHITECTURAL DESIGN
FOR THE LAST 30 YEARS
AND COUNTING



Innovative Housing For Vulnerable Residents

We are thrilled, together with our Client CARE, at the prospect of obtaining planning permission for our innovative housing scheme in Haverhill, designed for vulnerable residents with dementia.

The key concept of the model is **living life as normal**. In practice this means the following:

- Small group living;
- Meaningful occupation;
- Social Activities; and
- Freedom to roam within a safe environment.

The primary objective of the model is to provide an environment where **residents are safe** and are therefore allowed as much personal freedom to live as natural a life as their condition allows.



Residents will live in groups in six-bedroom apartments with direct and secure outdoor access. This will incentivise an active life as well as **future-proofing** the community in case any of these small households were in need to be temporarily isolated during an epidemic, improving the **healthcare resilience**.

The village will provide facilities, clubs and activities for residents including a pub, restaurant, supermarket, village hall and hobby rooms. Residents' care programmes will allow and encourage them to remain **active and engaged**.

The layout of the village will provide small and intimate squares and streets to help residents feel at ease. These external spaces are crucial to allowing freedom to wander for residents in a manner which both feels safe and is safe.

Following this success, JBA have also been appointed by CARE to work on a preliminary design for the introduction in Norwich of the innovative care home design already well received at the Haverhill site.

Sustainability And Wellbeing

Thanks to our forward-thinking Clients we are continuously experimenting and expanding the boundaries of our shared sustainability and wellbeing goals:

- **Envelope-First Approach** for both new built and refurbishment projects
- **Green Walls** introduced to increase our client staff's wellbeing, productivity and retention levels
- **BREEAM Excellent** new-built complex scheme with ScotchPartners and Peters Hay

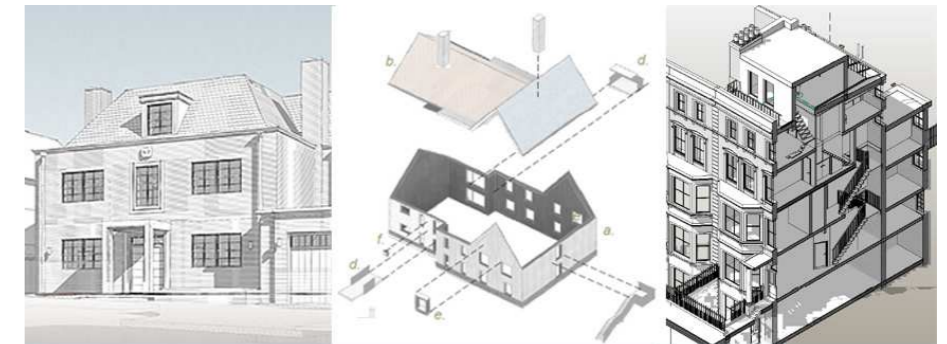

BIM Process Advances On Both New Built And Refurbishment

Together with our Clients, Design Team Colleagues and Contractors we are working and delivering on site, with BIM protocol and software, a series of schemes from planning to construction, delivering design ambition, on-site certainty and cost-saving on production that we are able to share with our Clients and partners.

We have shown that these advanced processes are applicable and proficient in both new built and refurbishment projects, in the design communication, production and delivery, challenging a diffused view in the design and construction industry that refurbishments require a simplified approach. We do not believe this is the case, especially given the opportunities that the existing building stock offers in terms of reuse, embedded carbon and, very often, remarkable aesthetic quality, flexibility and resilience.